

Coaxial Spot Light IV-14mkII IHV IHVA

Power LED*

* Mounted to IHVA



Super-high luminance spot light

This is alternative LED coaxial light, using a halogen light guide light-source for telecentric lenses. Model IV-14 features small sized design of 14 mm in outer diameter and an affordable price; model IHV-18 features 18 mm in outer diameter and high luminance; and model IHVA-27 features super-high luminance that is 4 times as much as IHV-18 by adopting a unique optical design. Accordingly, it is applicable to a high-speed inspection and/or high-powered inspection. Other sizes of the rod end diameter are available upon request. Unit: mm

Model name	Irradiating color	Number of LEDs	Power Consumption (W)	Power Consumption	Outline drawing
IV-14Rmk II	R	1	0.24	*DC 12V type	1
IV-14□mk II	W/B/G	1	0.24		
IHV-18R-RX	R	1	1.4	IDC-700DV	2
IHV-18□-RX	W/B/G	1	1.4		
IHVA-27R	R	1	1.8	IDC-700SV	3
IHVA-27□	W/B/G	1	2.6	IDC-1400DV	

* Almost all of our power supply units of output DC12V are applicable, including IDP, IDV, IDTH, IDGA (IDC is not applicable).

★ □ represents W = white, B = blue, or G = green.

★ For the IHV/IHVA series

- For the applicable power supply, refer to the constant current light control power supply (p. 56).
- It can be connected to the power supply units other than IDC (IDP, IDGA, etc.), using the resistance box.
- The power consumption listed above is when connected to IDC.
- The LED used in the IHV/IHVA type has individual differences in the peak wavelength; therefore, even the same type products may vary slightly in color.

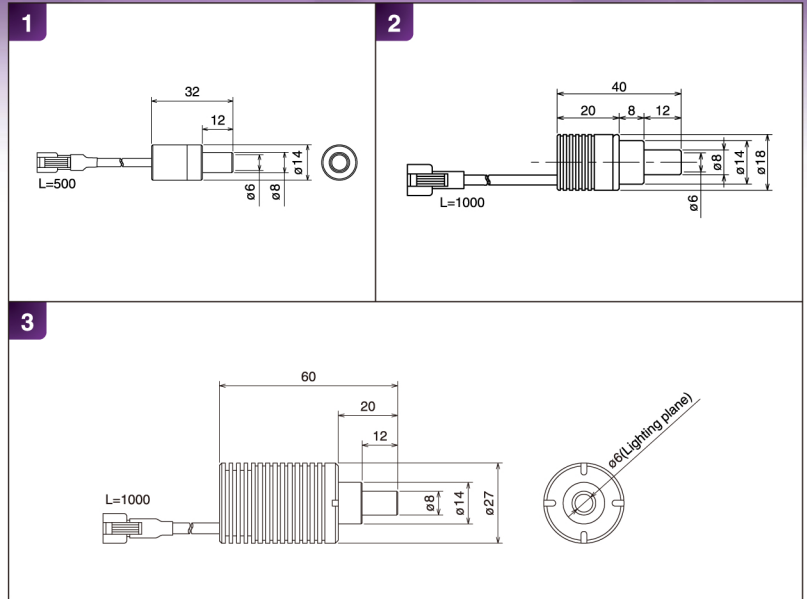

Option

Resistance Box / RBOX

This resistance box is to use the lighting using a power LED of the IHV/IHVA and IBF series with a power supply (IDP, IDGA, etc.) other than a constant current light control power supply (IDC). Using a power supply such as IDGA enables a wide range of applications, because digital light control is applicable, and two or more lighting devices can be connected to a single power supply unit.

Model name	Lighting used	Outline drawing
RBOX-22Ω	IHV-18-RX	1
RBOX3W-12R	IHVA, IBF, IHV-FX	2

Model name	Lighting power consumption when using the resistance box (W)
RBOX-22Ω	4.2W
RBOX3W-12R	* R:9.6W, W·G·B:8.4W

* IHV-FX only: 9.0 W for all colors

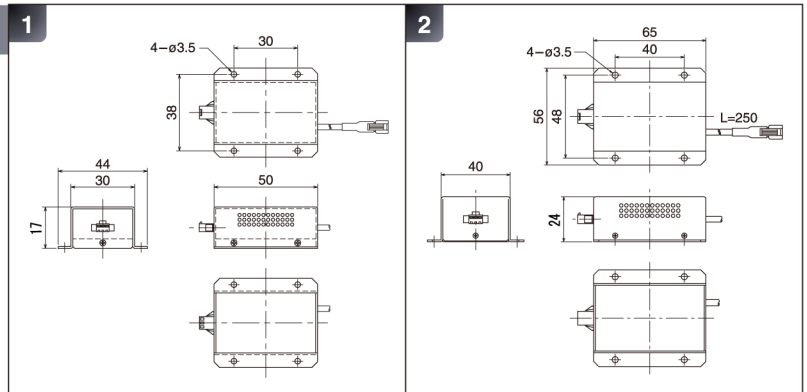

Example of use

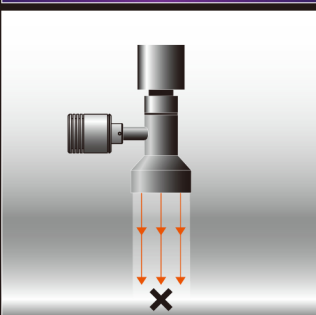

Example of the Image Photographed



It is possible to photograph at a shutter speed of 1/10000.

Work: Solder land on a board
Light: IHVA-27R
(at the maximum light quantity)

Luminance comparison of spot light

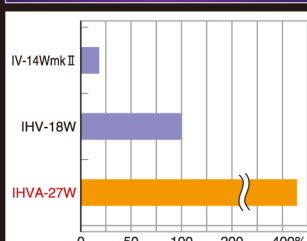

- The light quantity is increased about 4 times as much as our conventional products by reviewing the optical design.
- Variations of white, red, green, blue, yellow, and infrared lighting are available.

IHV/IHVA Type Wavelength Characteristic

