



Horizontal Ring Lighting

Main Applications Edge Detection Scratch Inspection Crack and Chip Detection

Suitable for the detection of small convex and concave defects on surface

Ideal to emphasize the edge-crack

Easy and flexible installation and adjustment with 360 degree lighting



Horizontal Ring Lighting

Series	Model No.	Color	Internal Ring Diameter (mm)	External Ring Diameter (mm)	Power Consumption	Drawing
ULRH Series	ULRH-46R75	Red	46	75	24V/1.9W	ULRH-46*75
	ULRH-46W75	White			24V/3.3W	
	ULRH-46B75	Blue			24V/3.3W	
	ULRH-60R96	Red	60	96	24V/2.4W	ULRH-60*96
	ULRH-60W96	White			24V/4.1W	
	ULRH-60B96	Blue			24V/4.1W	
	ULRH-110R146	Red	110	146	24V/3.8W	ULRH-110*146
	ULRH-110W146	White			24V/6.5W	
	ULRH-110B146	Blue			24V/6.5W	
	ULRH-170R206	Red	170	206	24V/5.8W	ULRH-170*206
	ULRH-170W206	White			24V/9.8W	
	ULRH-170B206	Blue			24V/9.8W	

Operating voltage: DC 24V

Green and IR850 are also available. Other wavelengths such as UV365, UV395 and IR940 are available upon request. Please contact us for details. Please refer to Page XX for standard items of UV365 and UV395.

ULRH-46*75

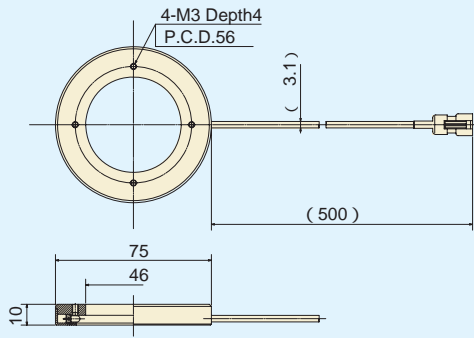

ULRH-60*96

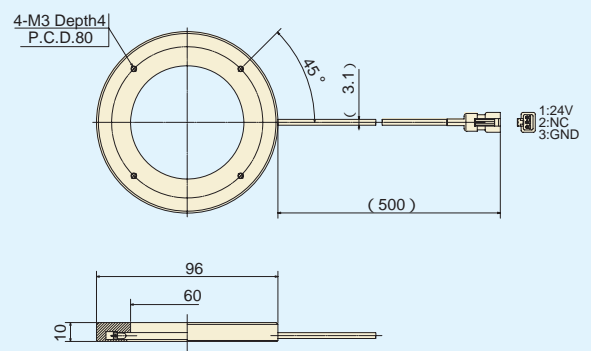

ULRH-110*146

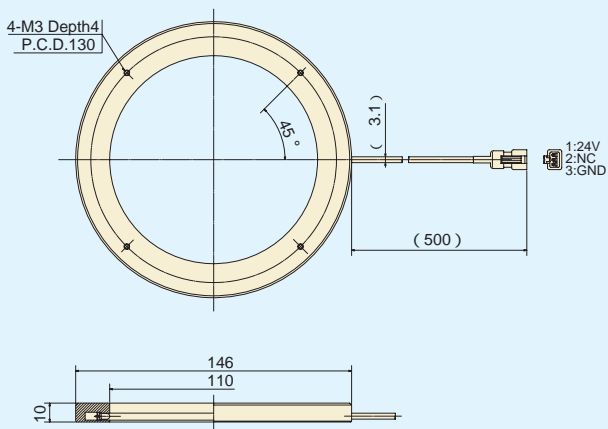

ULRH-170*206

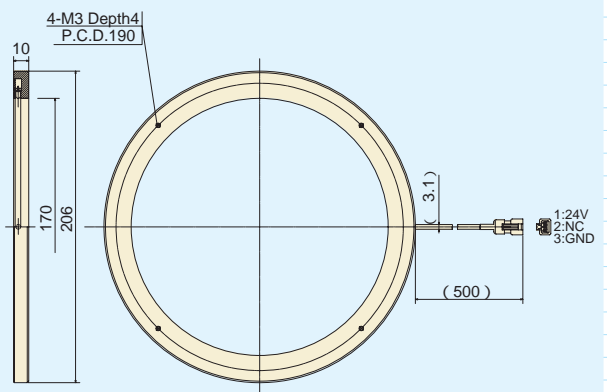

All dimensions in mm